

# W.TEC® SECURING

## Combi wedge lock washer

A flexible, quick and innovative bolt securing system

Würth Industrie Service GmbH & Co. KG  
Industriepark Würth, Drillberg  
D-97980 Bad Mergentheim  
T +49 7931 91-0  
F +49 7931 91-4000  
produktmarketing@wuertth-industrie.com  
www.wuertth-industrie.com

Responsible for the content:  
Marius Schmitt/MPM  
Editor:

Ruben Link/MPM

Reproduction, in whole or in parts, only with the approval of Würth Industrie Service GmbH & Co. KG.

© Würth Industrie Service GmbH & Co. KG  
Printed in Germany. All rights reserved.

MW - FA - AH - 500 - 03/17  
DBRO710004

Printed on environmentally friendly paper.

We reserve the right to make product changes at any time and without prior notice or information, if in our opinion the quality is improved by doing this. Illustrations are examples that may differ from the delivered goods. We reserve the right to make errors and we do not assume any liability for misprints. Our General Terms and Conditions apply.

WÜRTH Industrie Service

DE | EN

# W.TEC® SECURING

## Combi wedge lock washer

A flexible, quick and innovative bolt securing system



OUR PRODUCTS  
ARE AVAILABLE  
ONLINE 24/7

[eshop.wuertth-industrie.com](https://eshop.wuertth-industrie.com)

## Contact and persons in charge

In case of questions, do not hesitate to ask your responsible contact person or consult the colleagues from the Product marketing team under [produktmarketing@wuertth-industrie.com](mailto:produktmarketing@wuertth-industrie.com).

In cooperation with

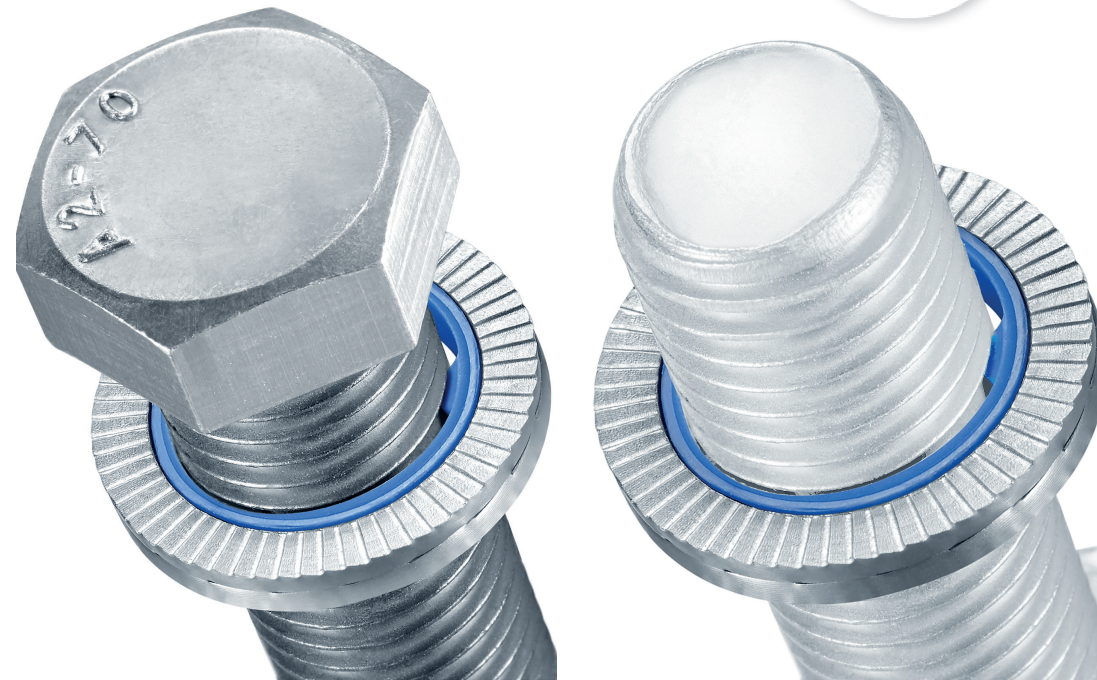

**A combined and at the same time efficient securing system for highly loaded bolted joints.**

The combi wedge lock washer ensures an easy and quick assembly, especially in difficult installation situations. You can easily use any standard bolt available on the market to experience the comfortable handling of the combi wedge lock washer.

**Advantages at a glance**

- Easy installation and safe locking due to inner lamellae
- Can be combined with every standard bolt
- Flexible in use for several bolt types
- Permanent securing and correct positioning of the combi wedge lock washer
- Reusable multiple times
- Cost savings due to increased productivity
- In steel and stainless steel with narrow and wide bearing surface
- Available from M8–M16

**Technical characteristics**

- Design Steel, fully hardened, 485 ± 25 HV0.3
  - Surface: Zinc flake coating\*
  - Corrosion resistance: 600 hours without Fe corrosion
- Design Stainless steel A4, 1.4404, surface hardened >520 HV0.05
- Special materials: INCONEL®718 or 254SMO®(1.4547) available on request
- Inner ring made of thermoplastic elastomer (TPE)

**Tailored to customer requirements**

You can easily use your own existing bolts to assemble them with the combi wedge lock washers. Be flexible in your decision whether to do this step on your own or we deliver the already pre-assembled combination of bolt and washer.

Every standard bolt can be used with the combi wedge lock washers. This possibility let you save storage costs and reduce your assembly times!

\* chromium(VI)-free

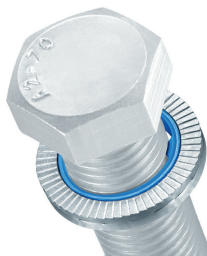
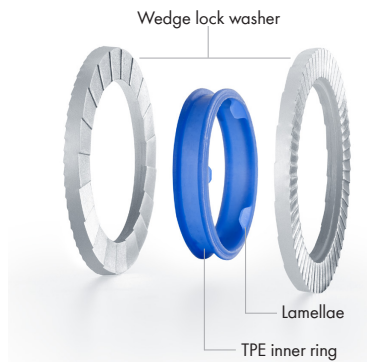

**STEEL, NARROW SHAPE**

For metric threads	Outer Ø [mm]	Art.-no.
M8	13.5	<b>0401796008</b>
M10	16.6	<b>0401796010</b>
M12	19.5	<b>0401796012</b>
M16	25.4	<b>0401796016</b>

**STEEL, WIDE SHAPE**

For metric threads	Outer Ø [mm]	Art.-no.
M8	16.6	<b>0401795008</b>
M10	21.0	<b>0401795010</b>
M12	25.4	<b>0401795012</b>
M16	30.7	<b>0401795016</b>

**STAINLESS STEEL A4, NARROW SHAPE**

For metric threads	Outer Ø [mm]	Art.-no.
M8	13.5	<b>0404796008</b>
M10	16.6	<b>0404796010</b>
M12	19.5	<b>0404796012</b>
M16	25.4	<b>0404796016</b>

**STAINLESS STEEL A4, WIDE SHAPE**

For metric threads	Outer Ø [mm]	Art.-no.
M8	16.6	<b>0404795008</b>
M10	21.0	<b>0404795010</b>
M12	25.4	<b>0404795012</b>
M16	30.7	<b>0404795016</b>